

Drop-Forged Chain

General Information (*Indicates a required field)

Name

Street Address

Email

Company

City

State

Zip Code

Phone

Chain Specifications

Please use the references provided below when completing this section.

Length

Chain Series

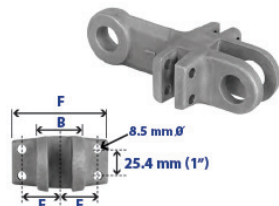
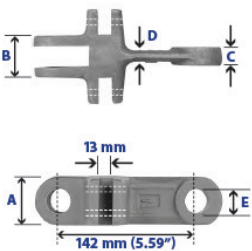
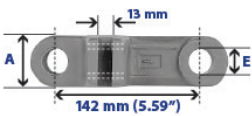
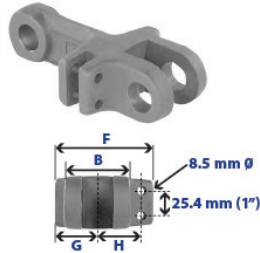
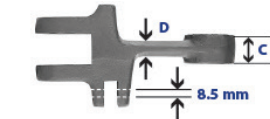
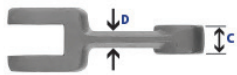

COMMON SERIES CHAIN

Chain Series	Ultimate Strength	Working Load	Weight	A	B	C	D	E	Recommended Sprocket Type
102 HVY	38,000 Lbs	6,900	0.99	1.375"	1.26"	0.55"	0.354"	0.709"	Symmetrical Only
	17,275 Kg	3,135	0.45	35 mm	32	14	9	18	
142 STD	73,000	13,000	2.45	1.97"	1.65"	0.75"	0.47"	0.98"	Symmetrical
	33,180	5,910	1.11	50	42	19	12	25	
142 HVY	99,000	18,000	3.74	1.97"	2.44"	1.14"	0.63"	0.98"	Symmetrical
	45,000	8,182	1.7	50	62	29	16	25	
175N STD	135,000	24,540	5.9	2.36"	2.48	1.18"	0.87"	1.18"	Non-Symmetrical
	61,360	11,150	2.68	60	63	30	22	30	
260 STD	150,000	27,270	14	2.95"	2.76"	1.18"	0.79"	1.26"	Non-Symmetrical
	68,180	12,390	6.4	75	70	30	20	32	

DOUBLE SERIES CHAIN

Chain Series	Ultimate Strength	Working Load	Weight	A	B	C	D	E	F	G	H	Recommended Sprocket Type
142 STD/DBL	73,000 Lbs	13,000	3.41	1.97"	1.65"	0.75"	0.47"	0.98"	3.11"	1.30"	1.41"	Non-Symmetrical
	33,180 Kg	5,910	1.55	50 mm	42	19	12	25	79	33	35	
142 HVY/DBL	99,000	18,000	4.72	1.97"	2.44"	1.14"	0.63"	0.98"	3.90"	1.69"	1.71"	Non-Symmetrical
	45,000	8,182	2.15	50	62	29	16	25	99	43	43.5	
175 STD/DBL	135,000	24,540	7	2.36"	2.48"	1.18"	0.87"	1.18"	3.78"	-	-	Non-Symmetrical
	61,360	11,150	3.2	60	63	30	22	30	96	-	-	

TRIPLE SERIES CHAIN

Chain Series	Ultimate Strength	Working Load	Weight	A	B	C	D	E	F	Recommended Sprocket Type
142 STD/TPL	73,000 Lbs	13,000	4.07	1.97"	1.65"	0.75"	0.47"	1.41"	3.62"	Non-Symmetrical
	33,180 Kg	5,910	1.85	50 mm	42	19	12	35	92	
142 HVY/TPL	99,000	18,000	5.4	1.97"	2.44"	1.14"	0.63"	1.71"	4.42"	Non-Symmetrical
	45,000	8,180	2.45	50	62	29	16	43.5	112.3	

Flight Type

Please refer to the diagram below for reference.

Flight Type

Flight Dimensions

Flight Spacing

Note: If you would like to provide additional information, please do so in the box at the bottom of the page.

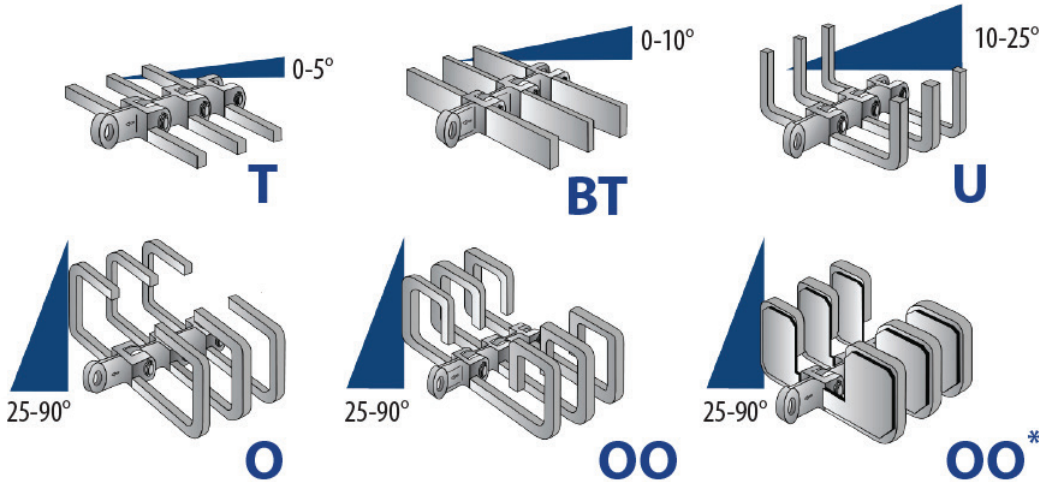

Chain Bolt Type

Please refer to the diagram to the right when completing this section.

Chain Bolt Type

Bolted Paddle

Optional, if yes, please proceed to the next field.

Material

Additional Application Details

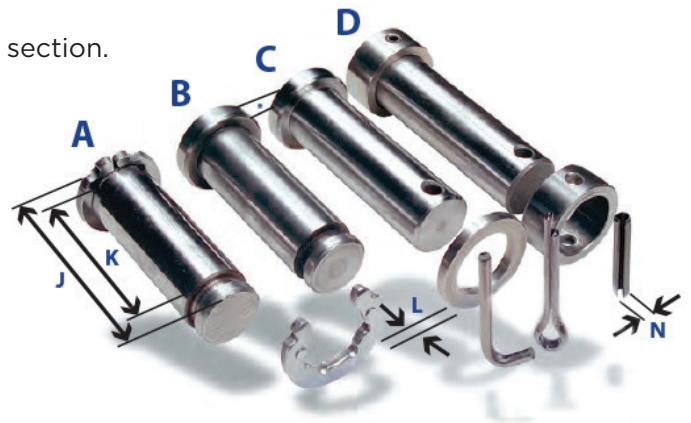

Bolt Types

- A:** The most widely used bolt; fastened using one clampwasher at each end.
- B:** Features an integral head (*8 mm) at one end and a clampwasher groove at the other.
- C:** Features an integral head (*8 mm) at one end and uses a **flat washer/cotter/S' pin or collar/spring pin** combination on the other.
- D:** (Ring Bolt) This is secured using one collar and spring pin at each end.

CHAIN BOLT TYPES